

I used my NetFlix account authorized and linked it

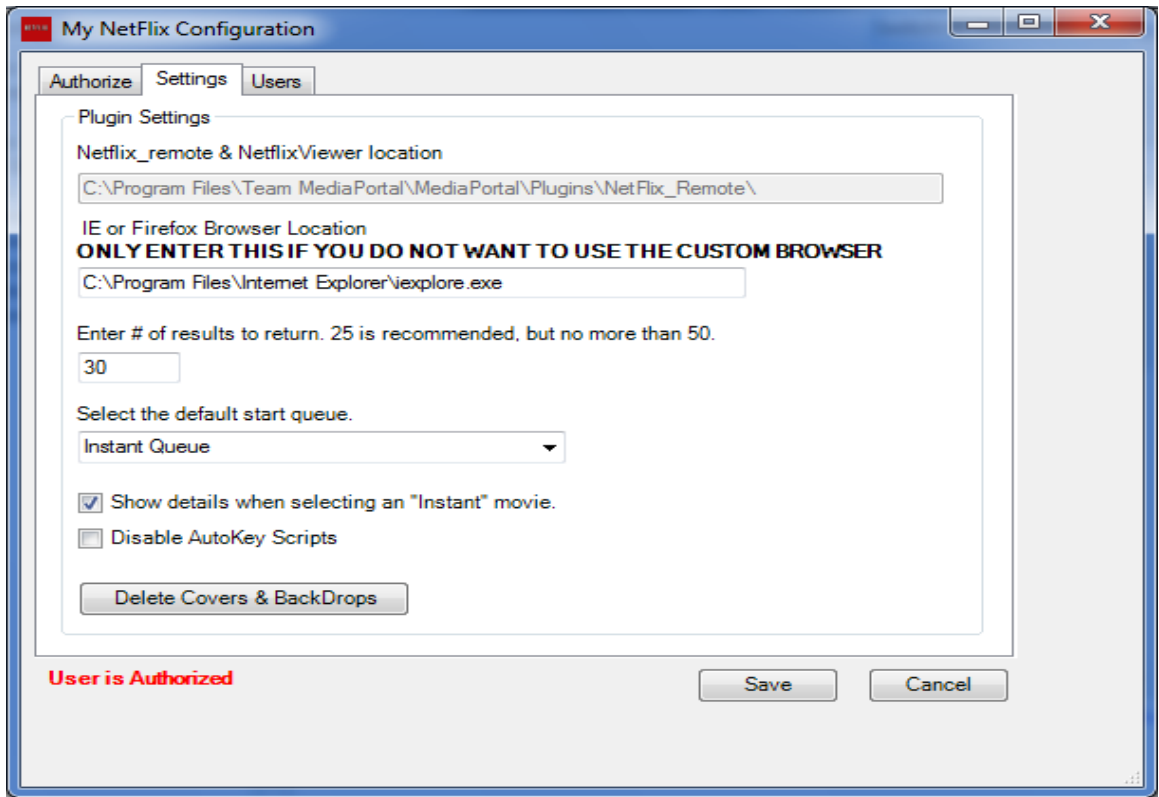

I also tried to configure without the browser location. I am using I.E 9

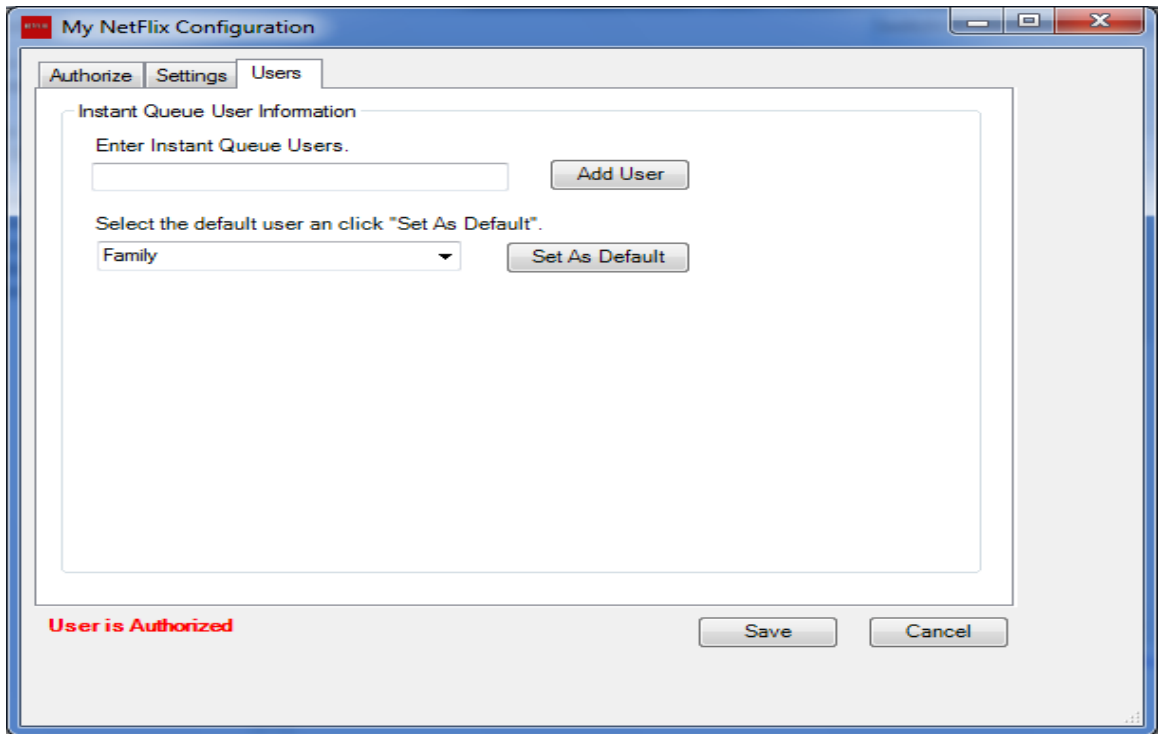

After entering MediaPortal and selecting the NetFlix plugin, I get the screen below. The browser never opens.

My NetFlix - Instant Queue

#movieyear
#movieruntime
Rated #movierated
#availability

User Charles 0/0 Movies

Navigating to other screens within the plugin does not help and just produces similar

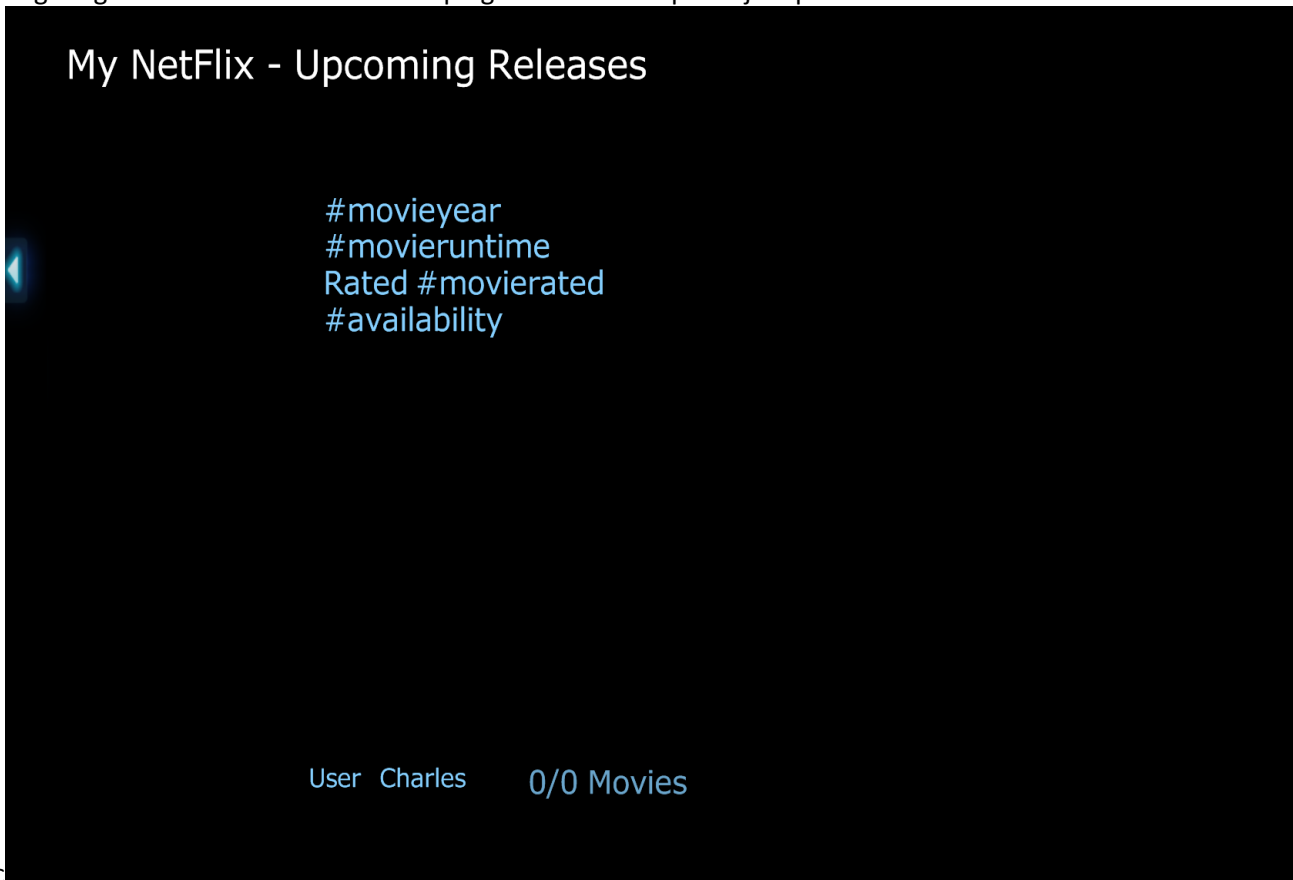

sc

Once I am in the plugin, I cannot navigate away from the plugin unless I exit and restart MediaPortal. Choosing the back button on the top of the bar has no effect.



Here is my startup screen